

# ELAN DOUBLE SKIN STEEL.

## APPEARANCE AND SAFETY

Elan is a high-quality double skin steel partitioning system which can be used in a wide range of applications where appearance, aesthetics and safety are important. Elan's aesthetic and physical properties make it very appealing for a multitude of working environments, such as factory partitioning, museum display areas, and laboratory offices. Elan is a cost-effective answer to all your space management problems.

This system is available in both non-fire and fire rated versions. Please contact us to discuss your requirements.

- » Integrated blinds are available, which are controlled with a portable dial - keeping the panel face free from unnecessary clutter.
- » Noise reduction capabilities can also be offered with potential noise reduction of up to 36 dB.
- » Completely demountable, enabling one panel to be removed without having to dismantle the whole enclosure.
- » Panels can be supplied in a fire-rated version to BS 476: Part 22:1987.

# ELAN PANELS

AS (all steel), SG (steel glass), GSG (glass-steel-glass) and SGS (steel-glass-steel) panels all come in the standard sizes below. A width of 1000 mm is available if the height is below 2438 mm.

AG (all glass) panels have less height options, however have the same width availability.

3657 mm	2743 mm
3048 mm	2438 mm
2743 mm	
2438 mm	
300 mm	300 mm
400 mm	400 mm
500 mm	500 mm
600 mm	600 mm
700 mm	700 mm
800 mm	800 mm
900 mm	900 mm
1000 mm	1000 mm

Tel: 01642 242228 | Fax: 01642 242259  
 www.richardsonsuk.co.uk | sales@richardsonsuk.co.uk

RICHARDSONS  
 MAKING WORKSPACE WORK

6 Collingwood Court  
 Riverside Park  
 Middlesbrough TS2 1RP



# Elan Doors



## Double Skin Steel and Sapele Veneer Doors

Elan hinged doors are available in two options, both steel and sapele. The doors can be installed with a wide range of accessories making them very versatile and suitable for many situations.

Elan doors are very popular in offices and factories, complimenting the Elan range of partitioning with matching window frames.



## Facts

Both doors as standard have stainless steel hinges, satin anodised aluminium round handle, 3 lever lock set and a satin anodised aluminium door closer. The steel doors are fitted with powder coated 100mm deep kick strips.

### Steel Door Dimensions:

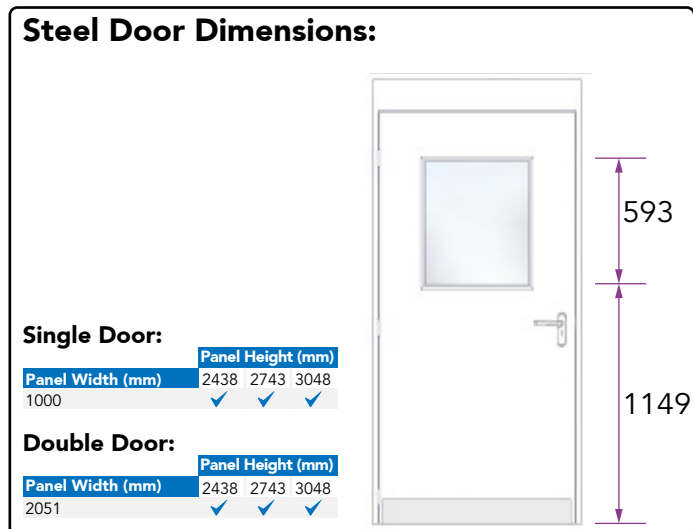

### Sapele Door Dimensions:

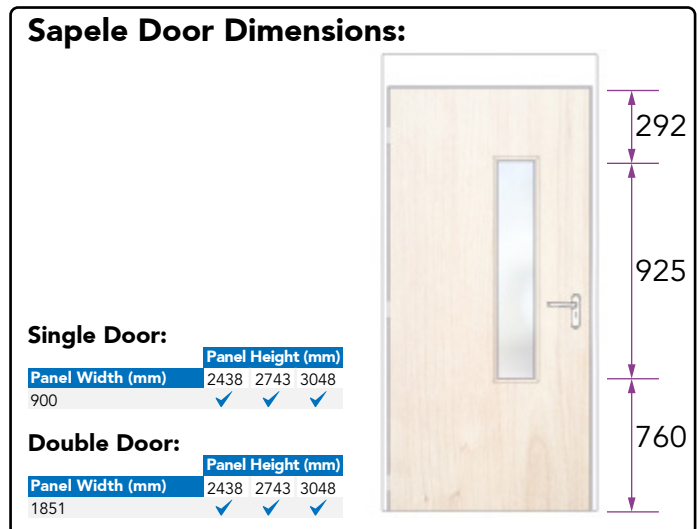

## Features and Options

- Vision Panels
- Stainless steel vision panel
- Digital lock
- Stainless Steel kick plates
- Euro lock
- Panic Bar
- Other locks and door furniture available upon request.
- Elan doors have been tested and are available with up to a one hour fire rating.

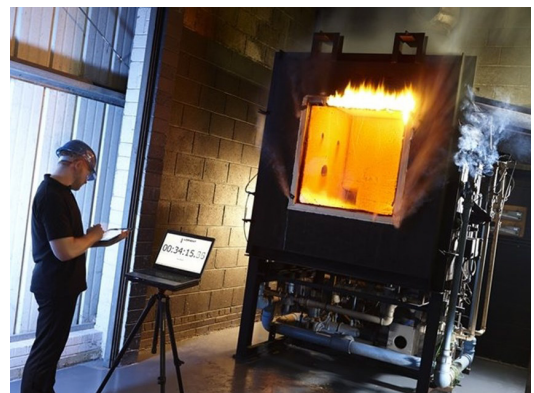

# Elan Sliding Doors

**TROAX**<sup>®</sup>

## Double Skin Steel Sliding Doors

Elan sliding doors provide the full aesthetic benefits that come with a Troax high quality double skin steel system.

The sliding door is the perfect solution for creating practical access points where space is at a premium. Multiple size options and accessories available making the sliding door suitable for numerous applications.



## Facts

Elan sliding doors are available in full steel and glazed options. All the sliding doors as standard have a claw lock and flush pull handle. Pelmet's are supplied to cover the track mechanism ensuring a clean and tidy finish.

A selection of trolleys are available to ensure a large variety of door sizes can be met.

Panels can be infilled with mineral wool and a variety of fire rated types of glass are available upon request.

Panel Width (mm)	Panel Height (mm)			
	2438	2743	3048	3657
1000	✓	✓	✓	✓
2000	✓	✓	✓	✓

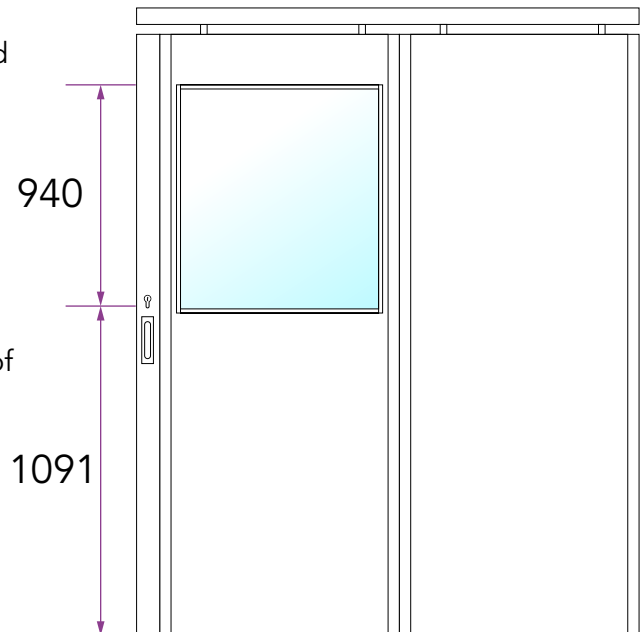

## Features and Options

- Claw lock (Deadlock)
- Claw lock (Euro cylinder)
- Upon request Sliding doors can be available with an increased height that can account for forklift access.
- Bi-parting sliding doors are also available to truly maximise a small space for storage.



# Troax Steel Panel Finishes

The finish of our steel panels is just as important as the initial design, we always prepare our products to the highest of quality. As soon as our products reach their site the modular design and high quality finish ensures they are ready for fast and clean installation.

## Standard Colours:

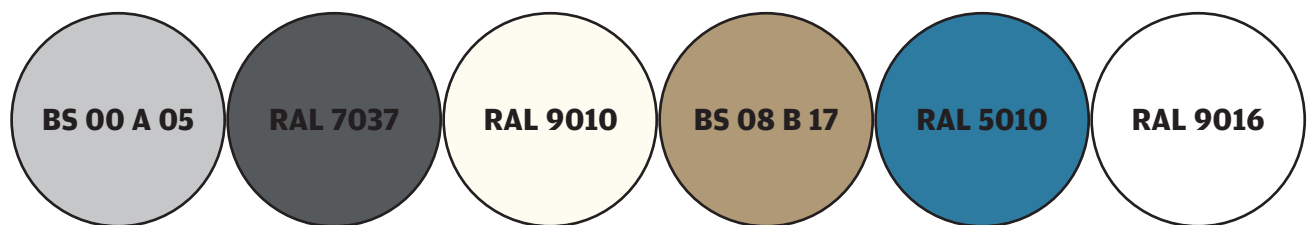

\*Sample colour swatches are available upon request

You are not limited by our standard colours as we can offer any colour as to your request.

## Special Finishes

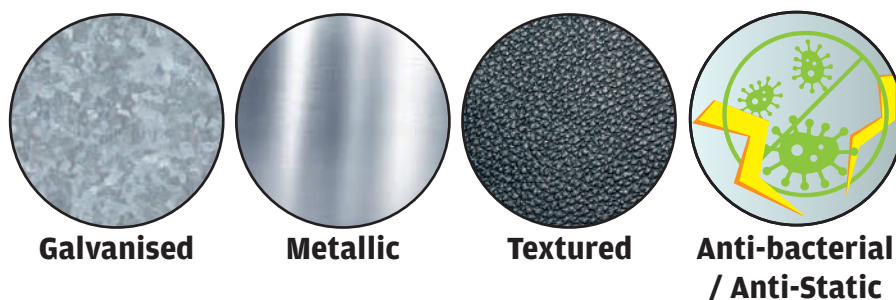

Galvanised

Metallic

Textured

Anti-bacterial  
/ Anti-Static



**RICHARDSONS**  
MAKING WORKSPACE WORK

6 Collingwood Court  
Riverside Park  
Middlesbrough TS2 1RP

**Tel: 01642 242228 | Fax: 01642 242259**

**[www.richardsonsuk.co.uk](http://www.richardsonsuk.co.uk) | [sales@richardsonsuk.co.uk](mailto:sales@richardsonsuk.co.uk)**





**RICHARDSONS**

MAKING WORKSPACE WORK

6 Collingwood Court  
Riverside Park  
Middlesbrough TS2 1RP

**Tel: 01642 242228 | Fax: 01642 242259**

**[www.richardsonsuk.co.uk](http://www.richardsonsuk.co.uk) | [sales@richardsonsuk.co.uk](mailto:sales@richardsonsuk.co.uk)**

# Elan - Double Skin Steel Partitioning

## Installation Pack



# Contents

Page 1	-	Contents
Page 2-7	-	Elan Partitioning
Page 8-13	-	Elan Sliding Door (King 1)
Page 14	-	SSS Handle
Page 15	-	Maintenance Information

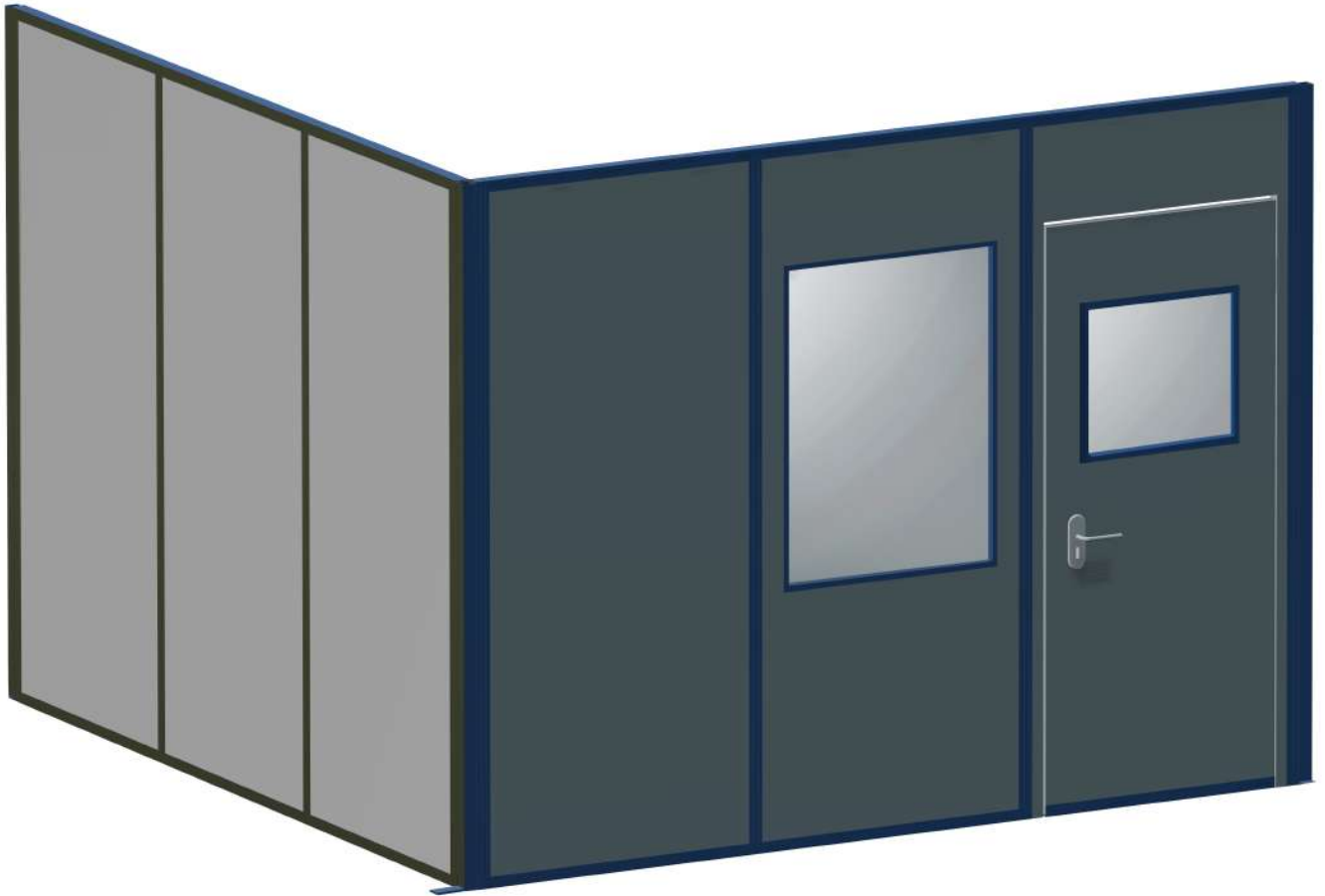

Drill with hammer action



Metal Shears



Tape Measure



Pliers or Mole Grips



etc



Screwdriver



# Beginning Installation

Before you begin:

- Identify all of the components for your installation.
- Choose a datum point from which to measure all positions of corners.
- Measure and mark up the lines of the walls with a chalk line, between the feature points.

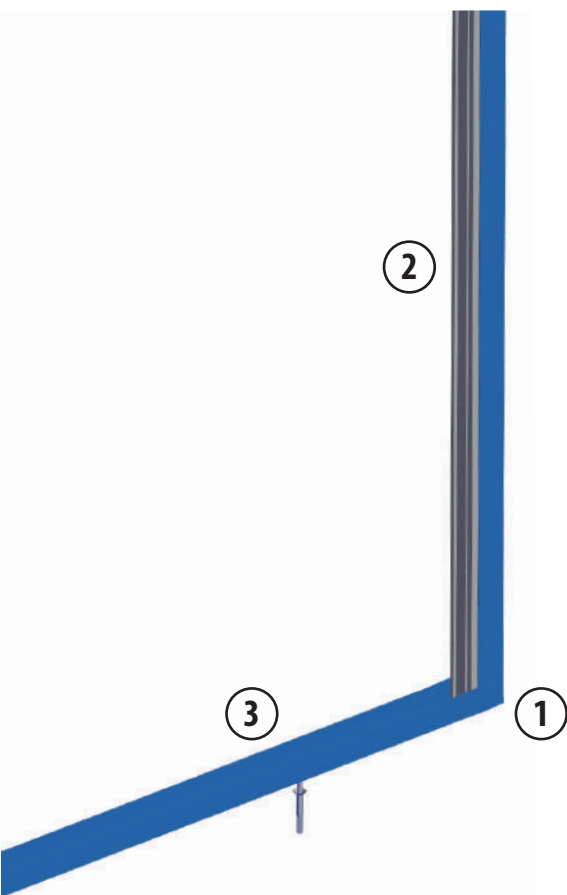

Fix the mullion to the floor using M10 x 100mm countersunk expansion bolts.

**If NOT fixing into concrete check the fix listed on the delivery notes.**

Ensure that the floor the mullion is fixing onto is level using a spirit level.

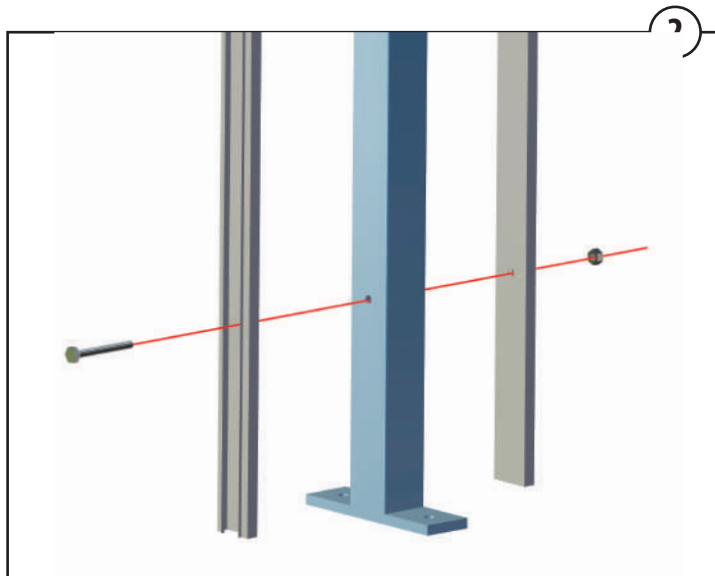
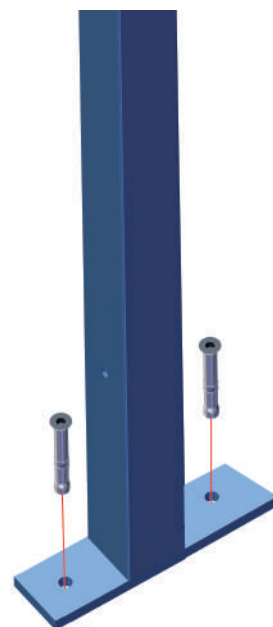

Apply 3mm bead of mastic seal to blank end before fixing in place.

Secure using M8 x 60 Bolt and Nuts.

Fix the floor channel to floor using M6 spit hit Fixing.

Fixings will be approx. 600mm apart.



**Note.**

See delivery note for type of track used



# Joining Panels and Mullions

Locate the panels into the floor track, with a distance of approx. 50mm apart.

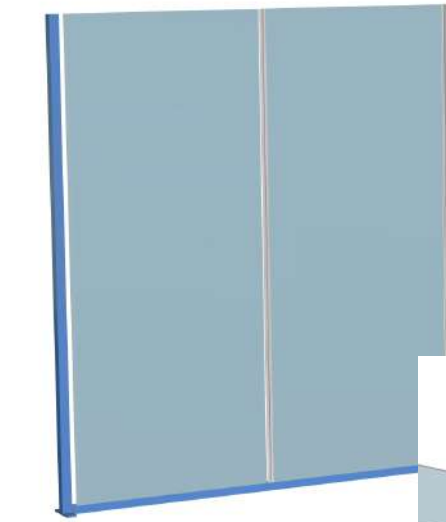
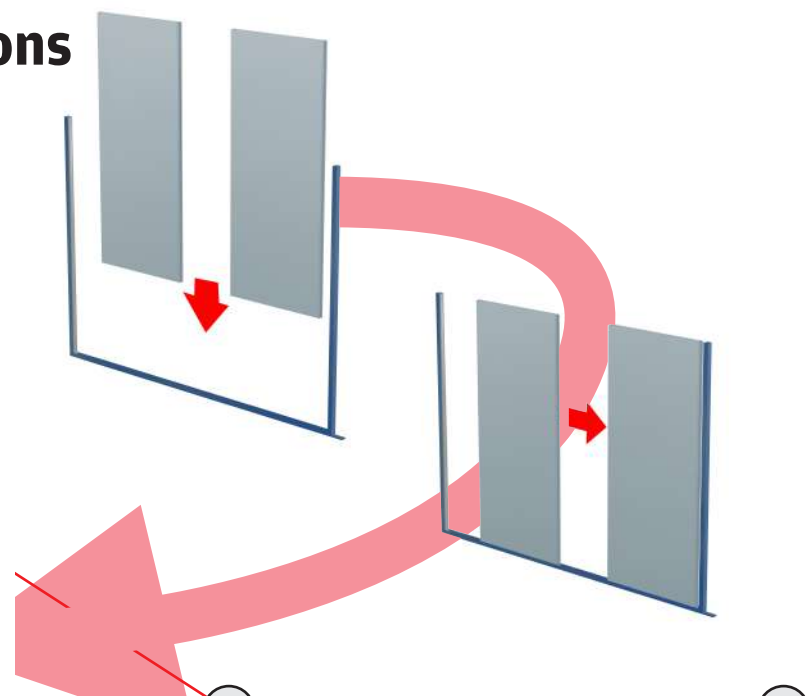

Insert the 'H' Cleat vertically as shown, positioned approx. 150mm from top and bottom.

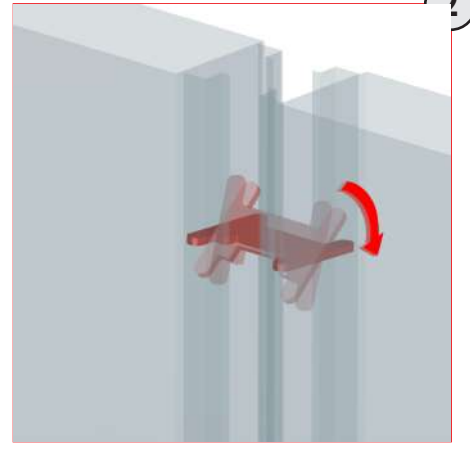
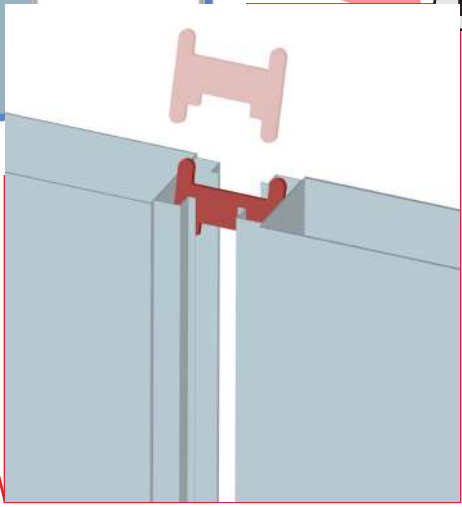

Rotate 'H' cleat with a pair of pliers.



Cleat / Spring Clip	Quantity
2438mm high =	5
2743mm high =	6
3048mm high =	6
3657mm high =	7

Place the spring clips in the cover channel, ensure they have slightly different spacing to the 'H' cleat to avoid collisions.

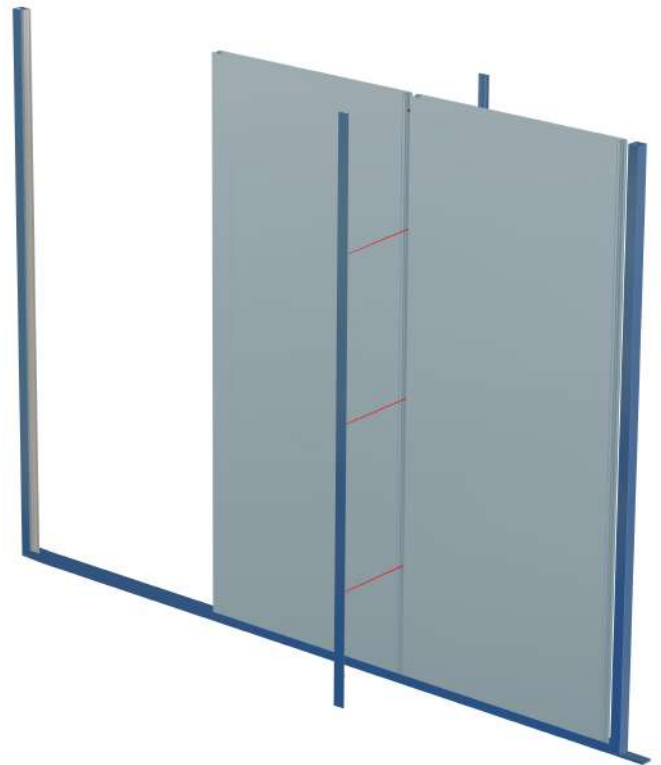

# Junctions and Corners

If required a corner panel will be provided the panels then connect together just as they did previously.

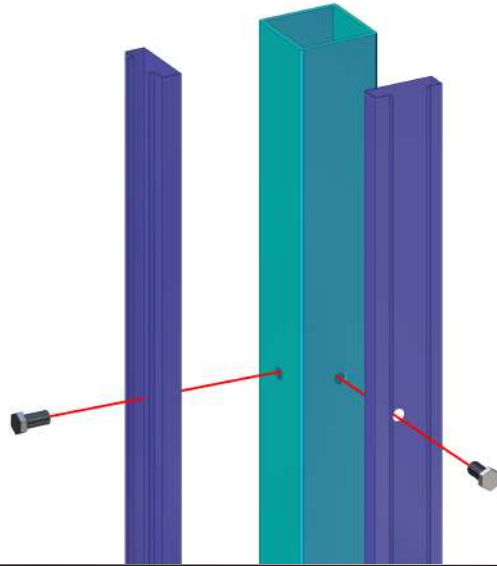

## Adding Fillers

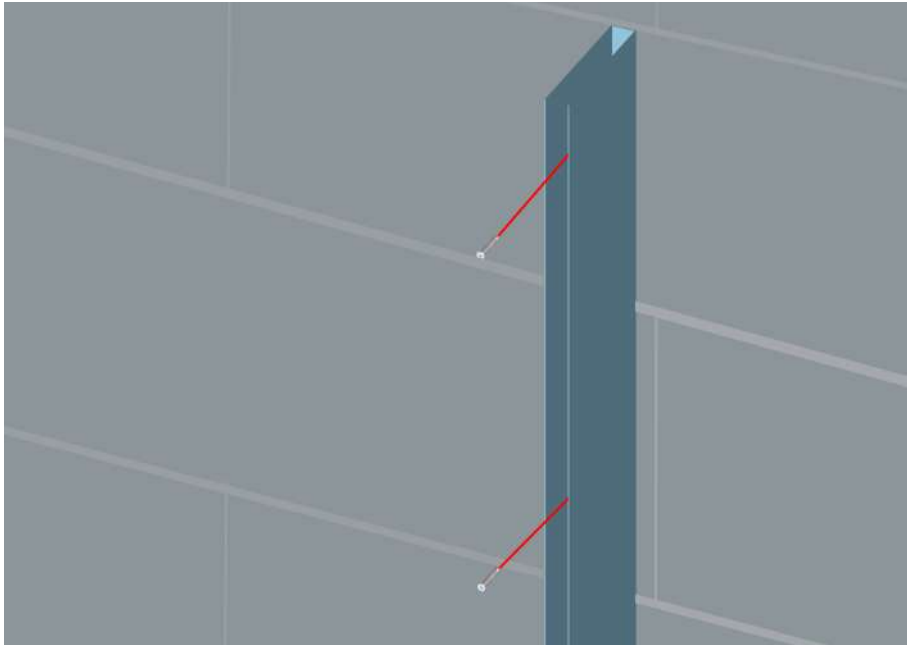

Cut filler panel to measured size.

Fix to wall using spit-hit fixings.

Repeat this step for all the pre-drilled holes.

The second part of the filler slotted in as shown.

Panels are then connected in the standard method.

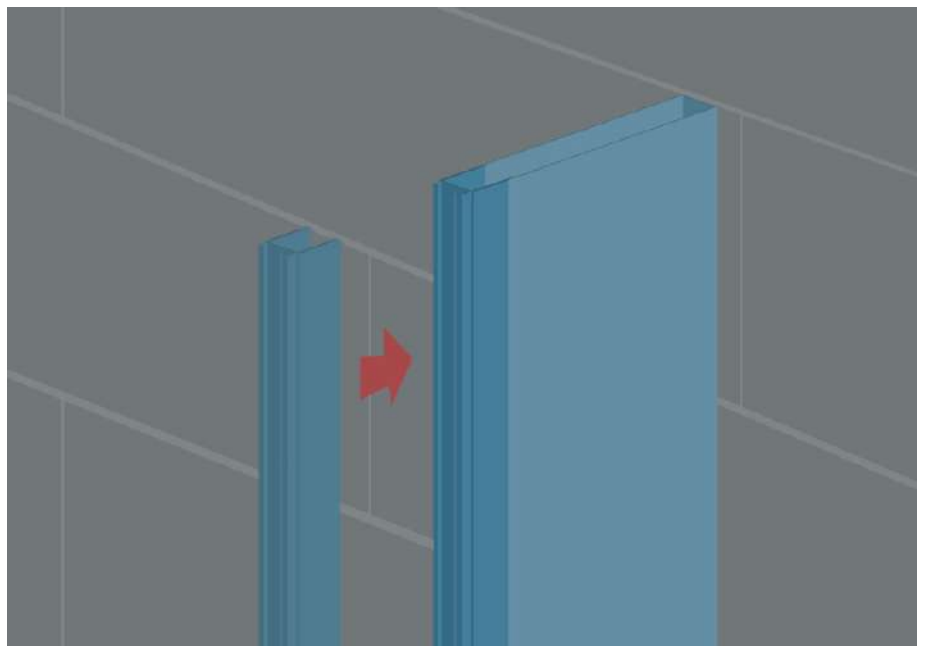

# Installing Top Caps

The top caps are cut to the lengths in relation to the panels.

As shown the top cap will push fit onto the top of the panels.

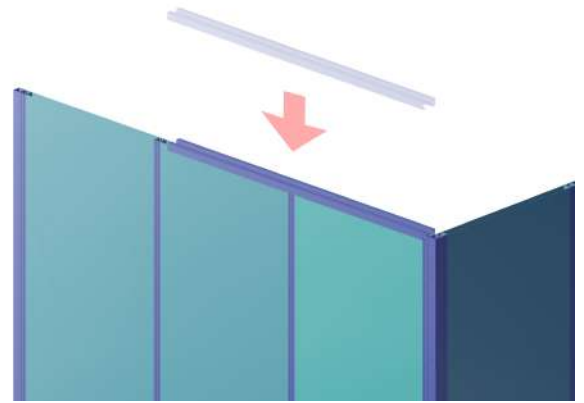

## 51 / 75mm Top Capping

Needs to be done prior to install if fixing to ceiling.

Insert top of panel into capping then panel lowered into floor-track

If free standing capping is fixed into face of panel.

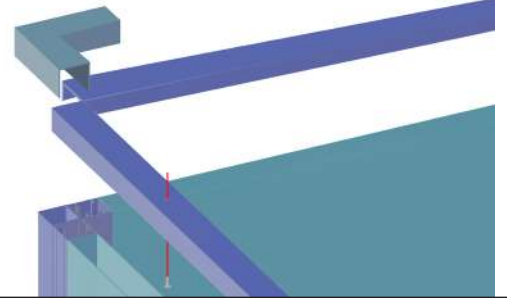

## Heavy Duty Top Capping

When the top capping meets on the same line fix the parts together as shown using skirting screws.

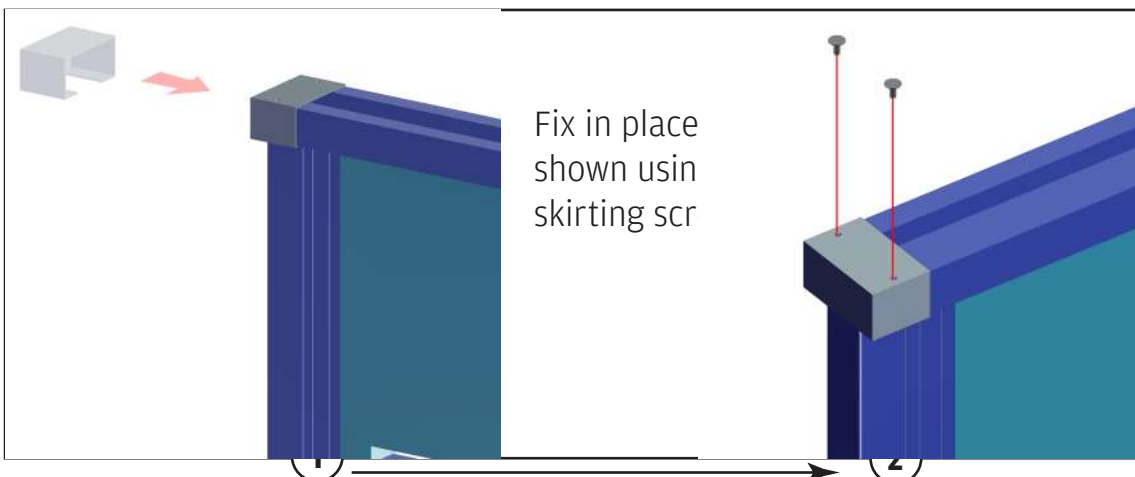
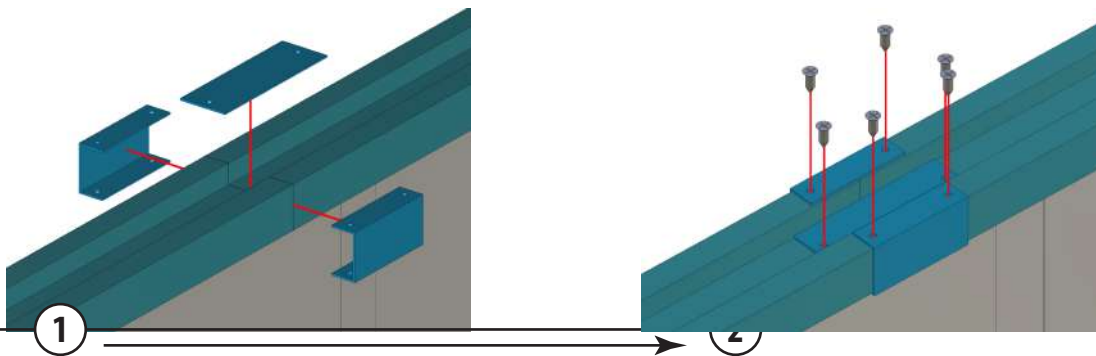

# Installing Skirting

Finish the panels by adding skirting to the base of the panels as shown.

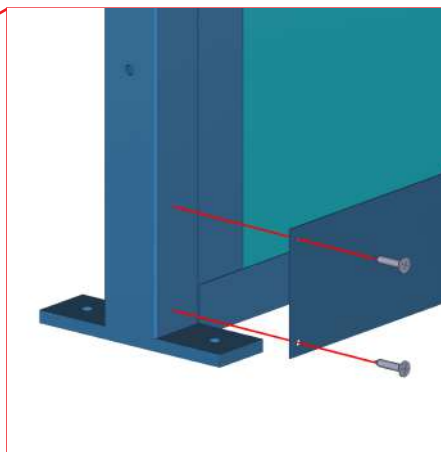
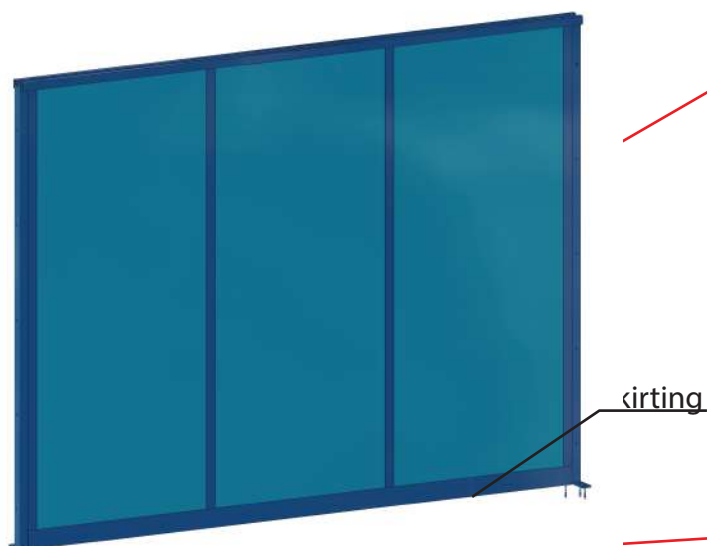

Fix the skirting to the panels using skirting screws as shown ensuring it is level with the floor.

## Single & Double Doors

Single doors usually come fitted into the door frame along with locks.

Remove the bracing strip at the bottom of the door frame before installation.

Double doors will need to be fitted together with provided fixings.

Install the completed frame into the run of partitioning.

Install the over panels.

A hole will need to be drilled into the floor and top lintel to accommodate the flush bolt locking mechanism for double doors.

**\*If door closers are to be fitted, install instructions will be provided.**

## Tear Drop Seals

If supplied, tear drop seals should be applied to the door frame.

The hinge and top sides should be the same, the lock side should be different.

Apply as shown.

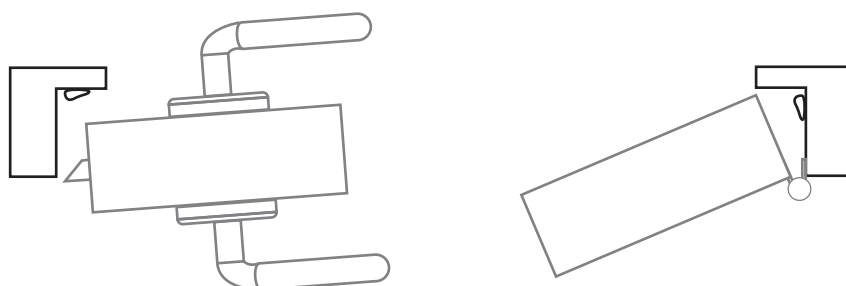



Drill with hammer action



Metal Shears



Hacksaw



Tape Measure



Pliers or Mole Grips

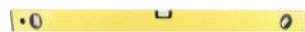

Spirit Level

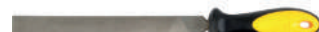

File



Screwdriver



Adjustable Spanner



Set Square



Hammer

# Installing Over Panel

Once the panels are installed a gap will be left for the door.

There will be two lintel cleats welded onto the mullions situated as shown.

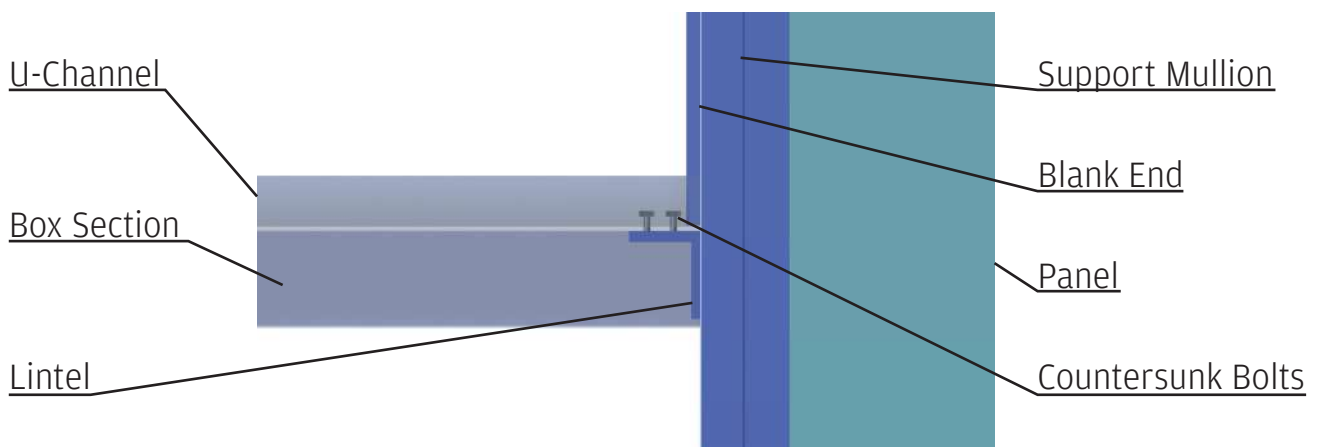
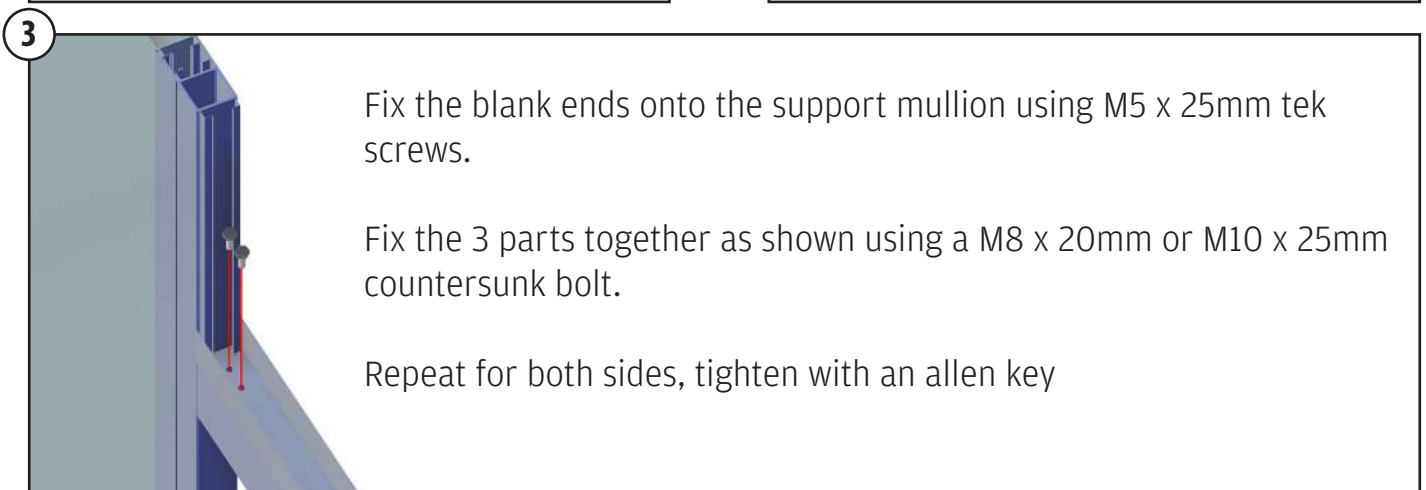
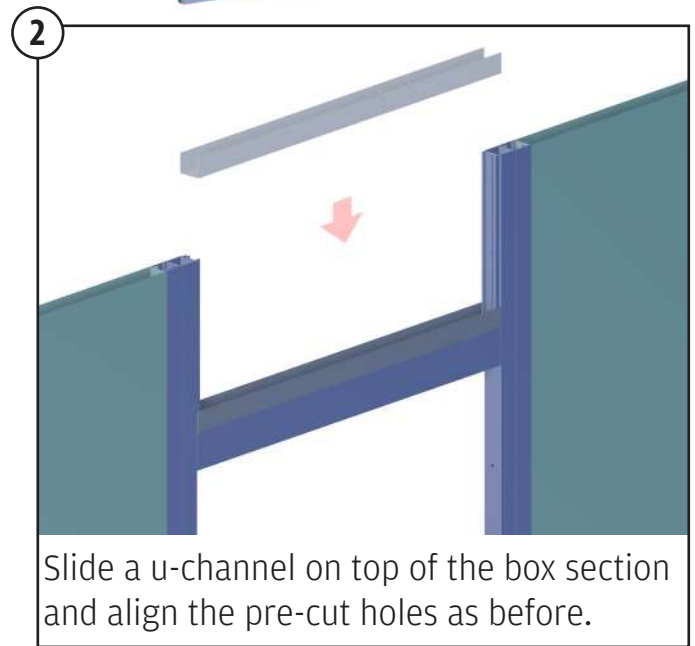
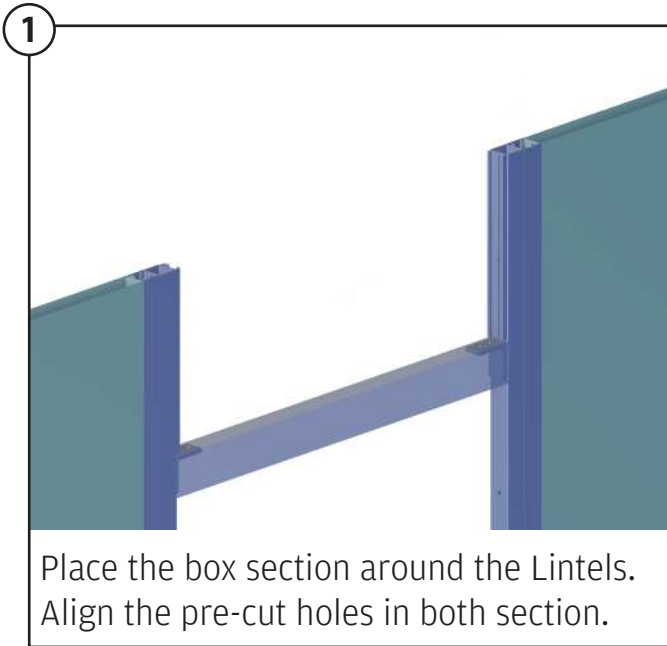
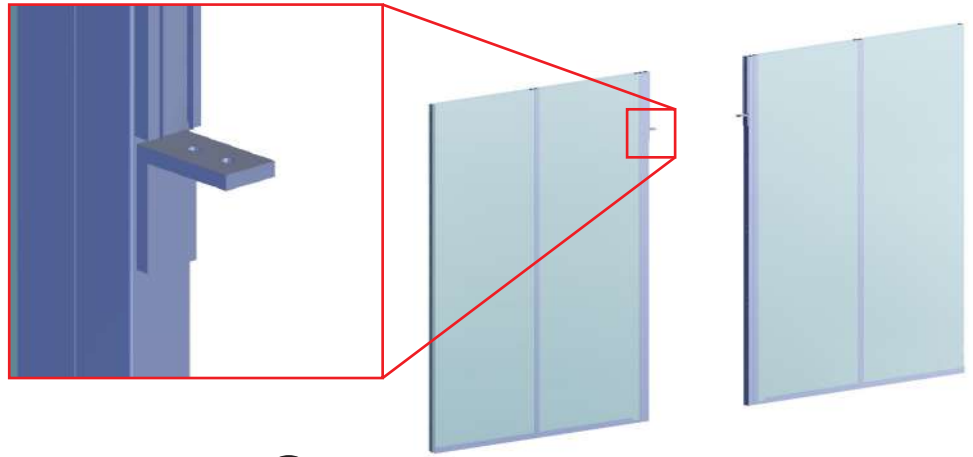



4

Slide the over panel into the u-channel as shown.

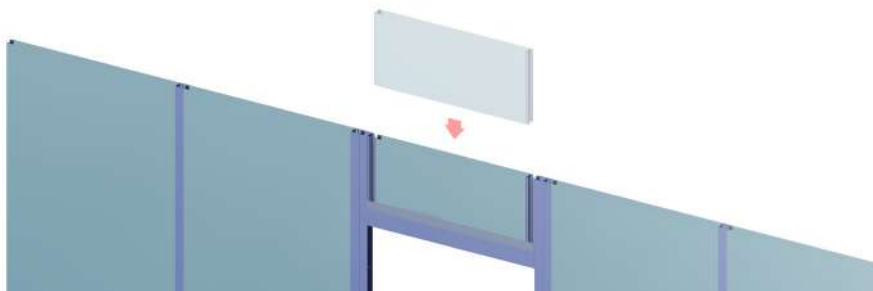

5

Install using standard method as shown.

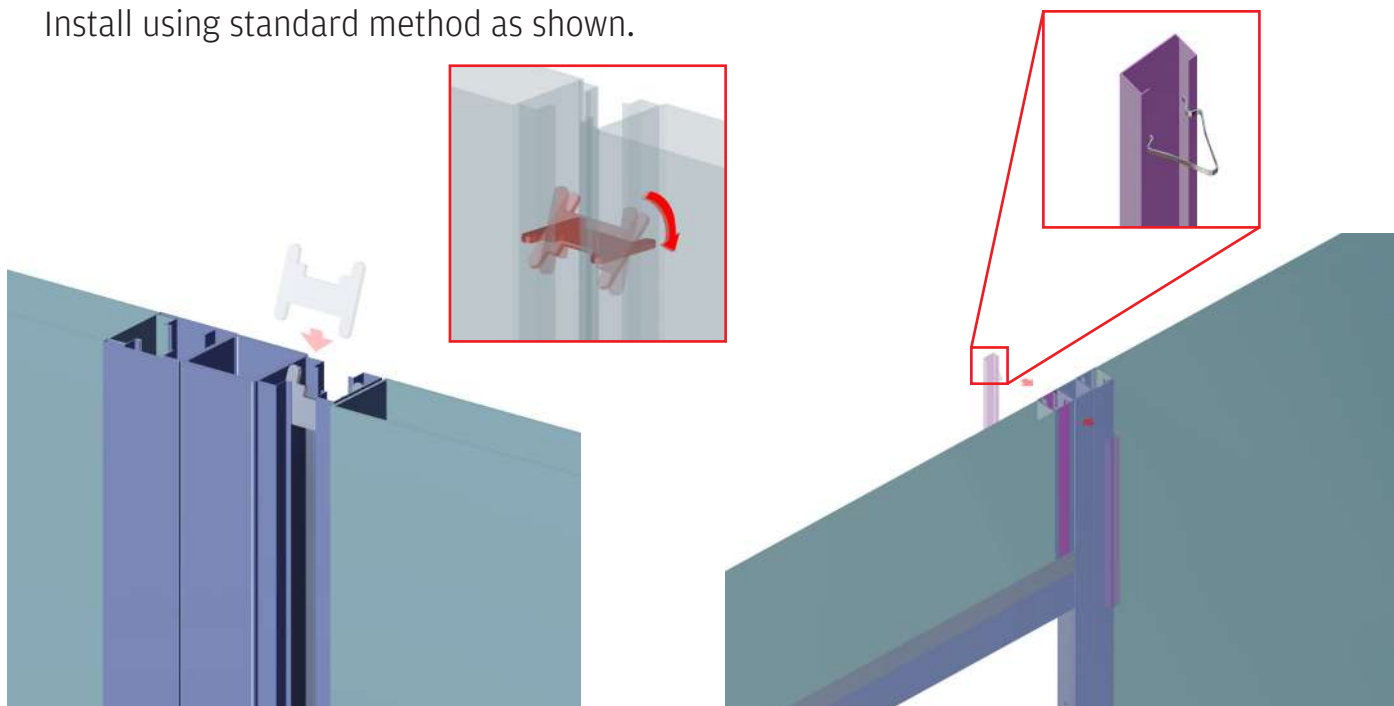

## Fitting the Track

Leave one end open to allow the track to be inserted.

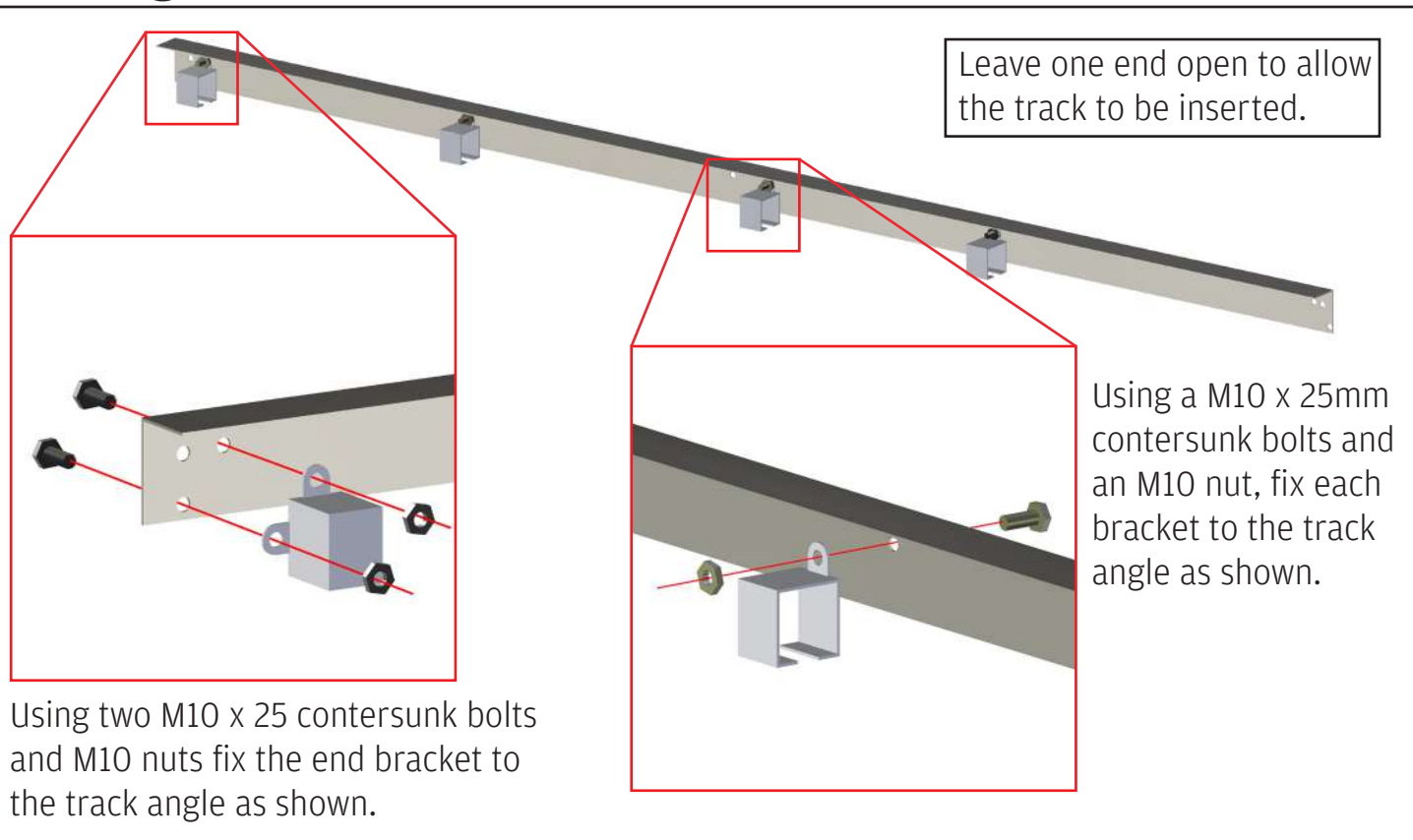

Using two M10 x 25mm contersunk bolts and M10 nuts fix the end bracket to the track angle as shown.

Using a M10 x 25mm contersunk bolts and an M10 nut, fix each bracket to the track angle as shown.

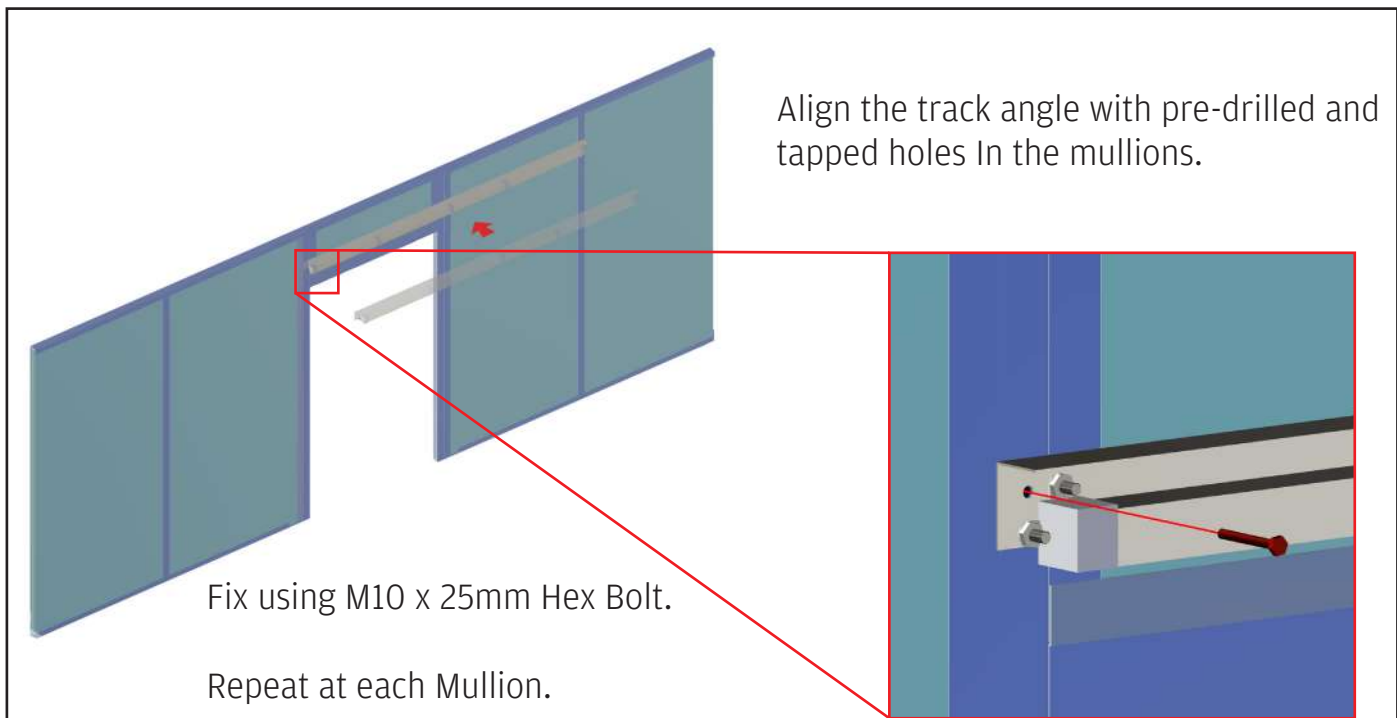
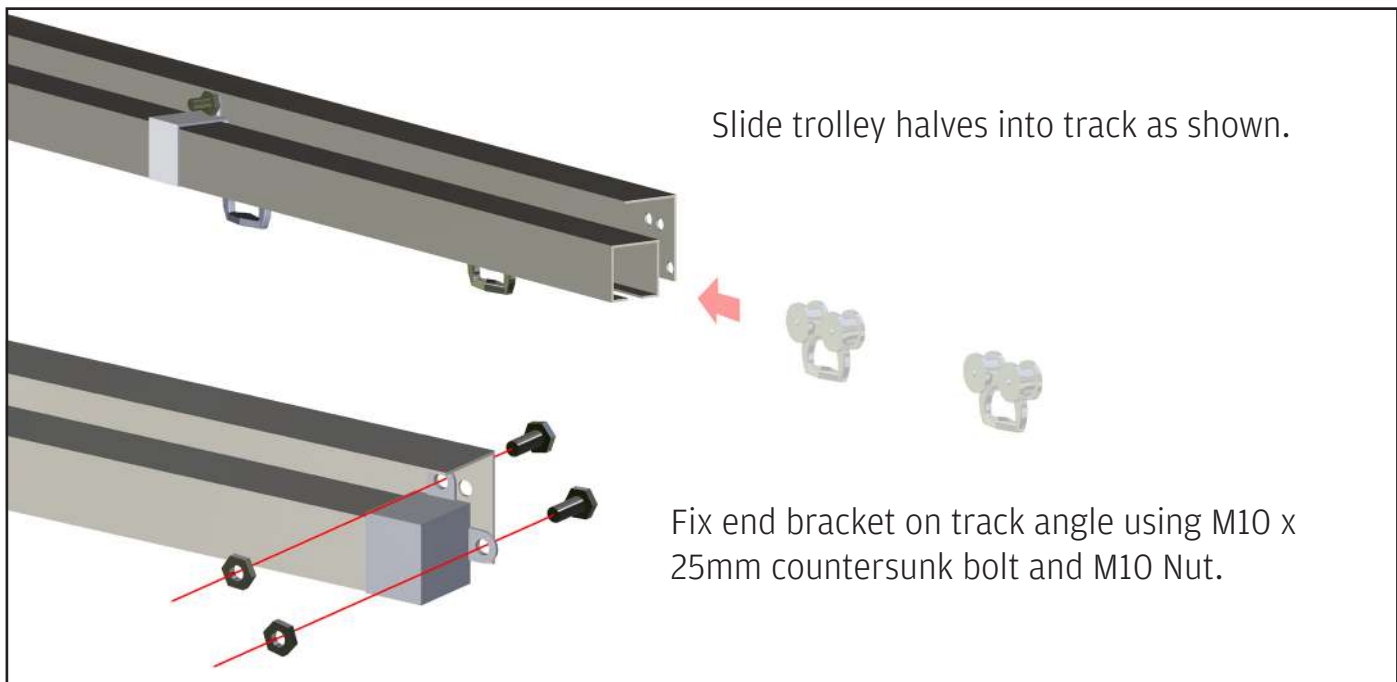
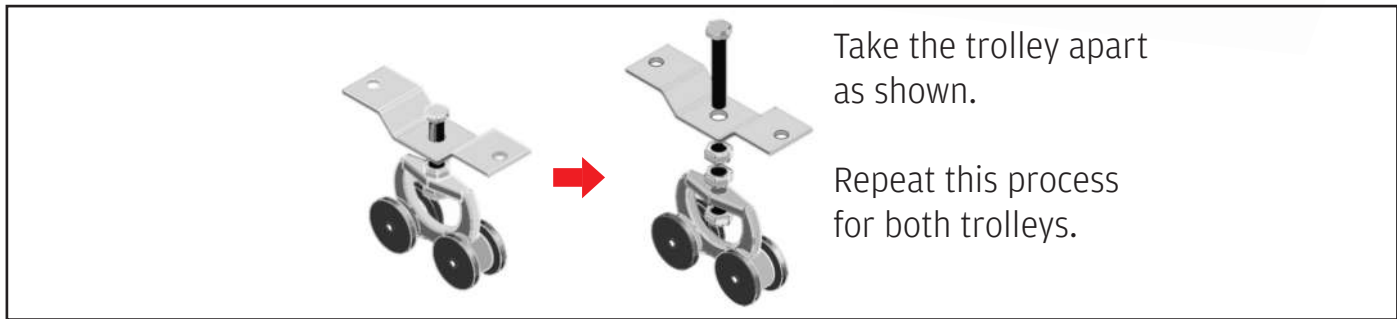
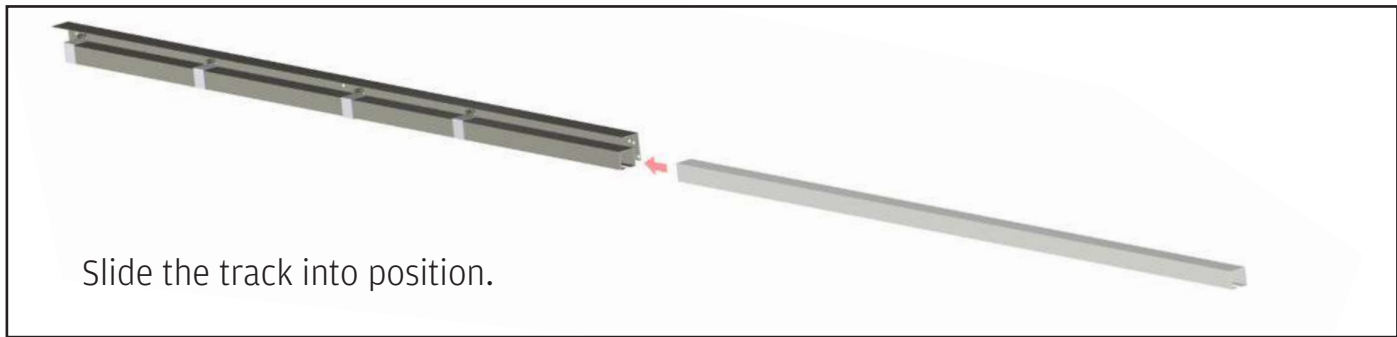

# Attaching Covers and Guides

1. Pelmet
2. Floor Guide
3. Floor Track

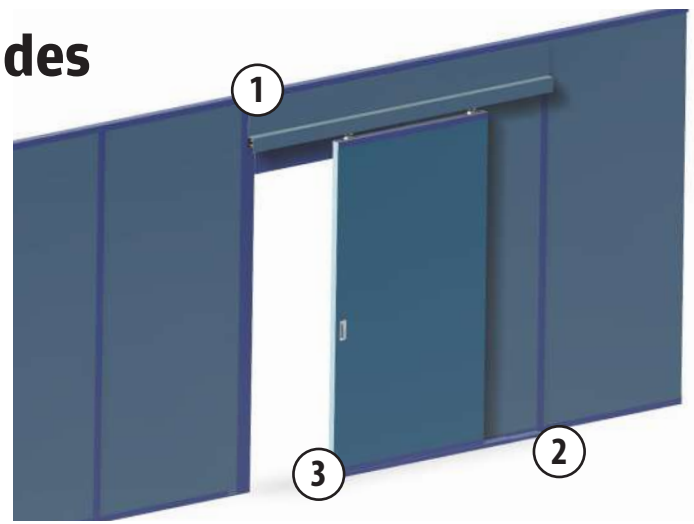

1

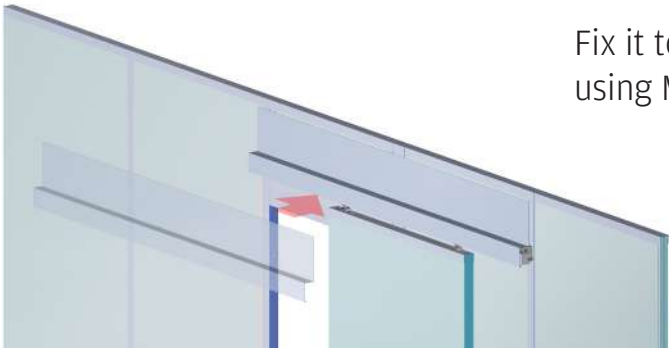

Fix it to the either the top capping or the overpanel using M12 x 19mm pan head screws.

2

Using the pre-holes in the floor guide drill 6mm holes in the floor. Guide fits level with edge of mullion.

Fix using push spithit fixings.

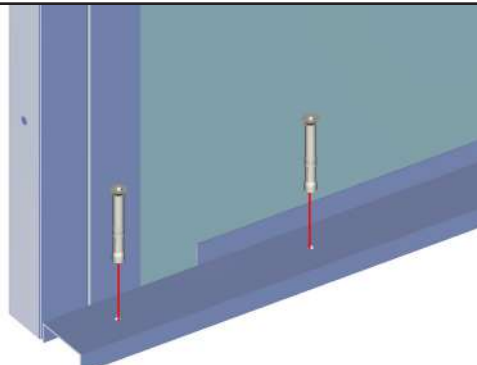

3



Slide the floor track over the base of the door as shown.

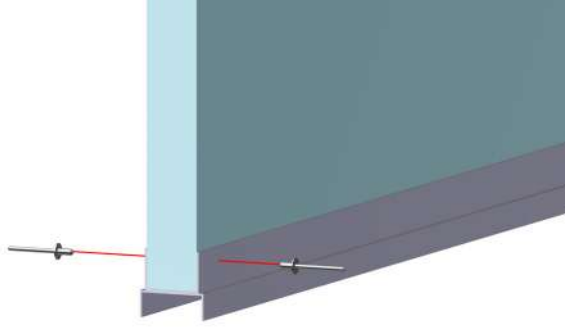

Pop rivet into position at each corner and at approx. 300mm intervals.

# Attaching the Sliding Door

Fix the second half of the trolley onto the trolley bracket using M8 x 25mm bolts and M8 nuts.

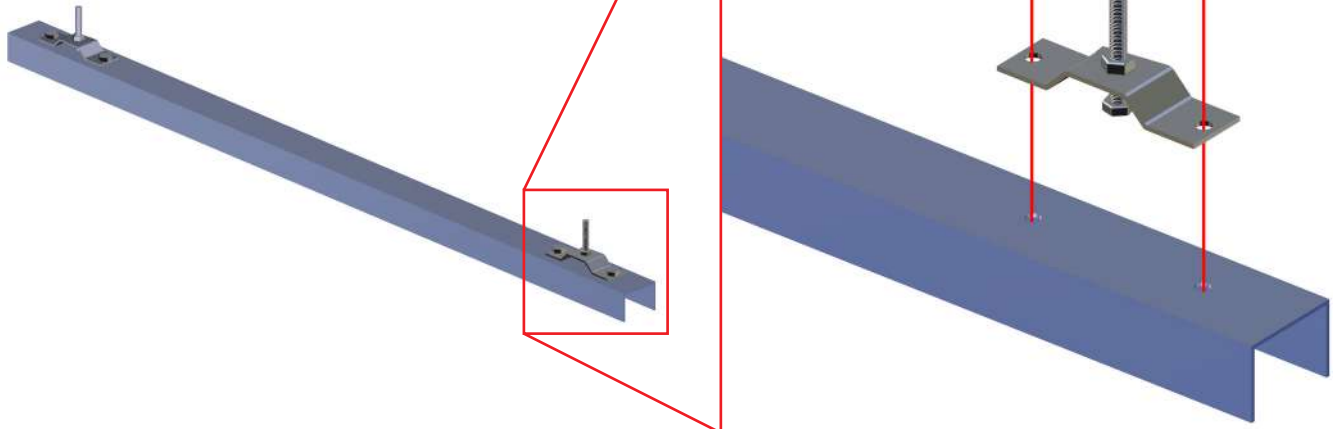

Slide the door panel into the trolley bracket as shown.

96mm lock box connected using standard fixing attachments.

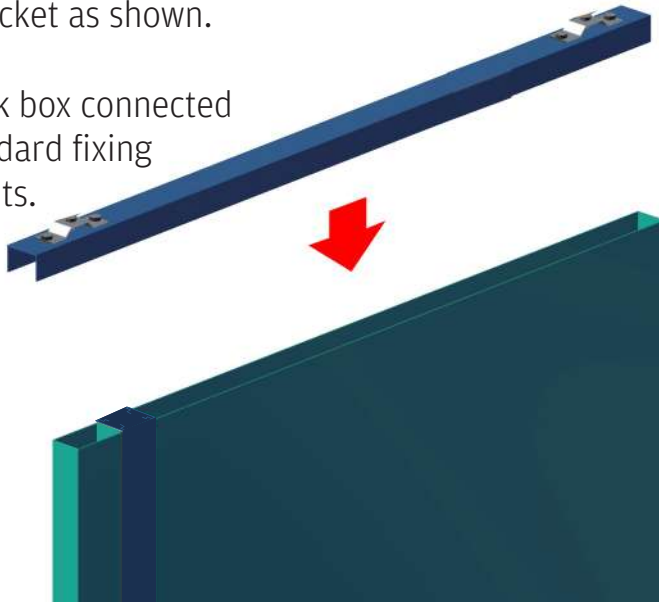

Pop rivet trolley bracket to the door in the top corners of the door and between with a spacing approx. 500mm.

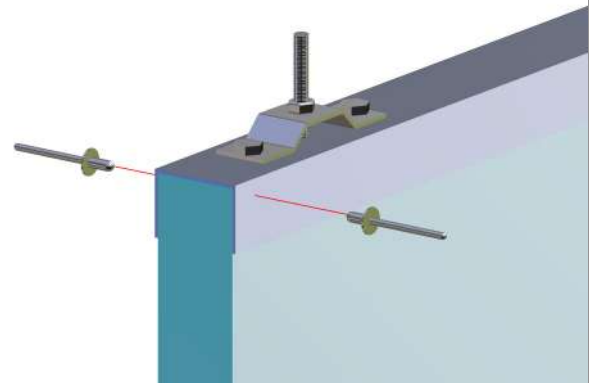

Re-assemble the two trolley halves to fix the door to the track.

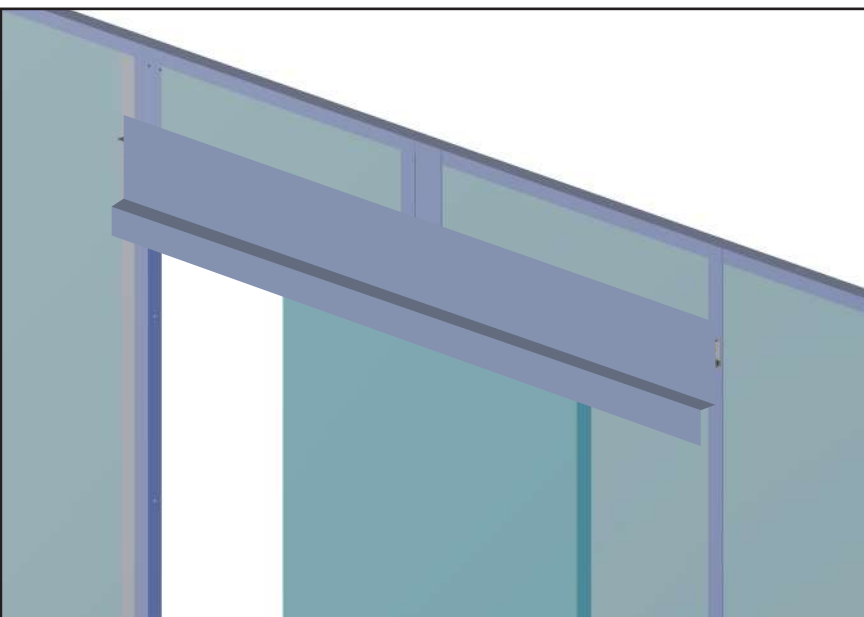

# SSS Handle

All Fixings must be used when installing the SSS Handle.

- 2 x Grub Screw
- 2 x Through Fixings
- 8 x Rivets

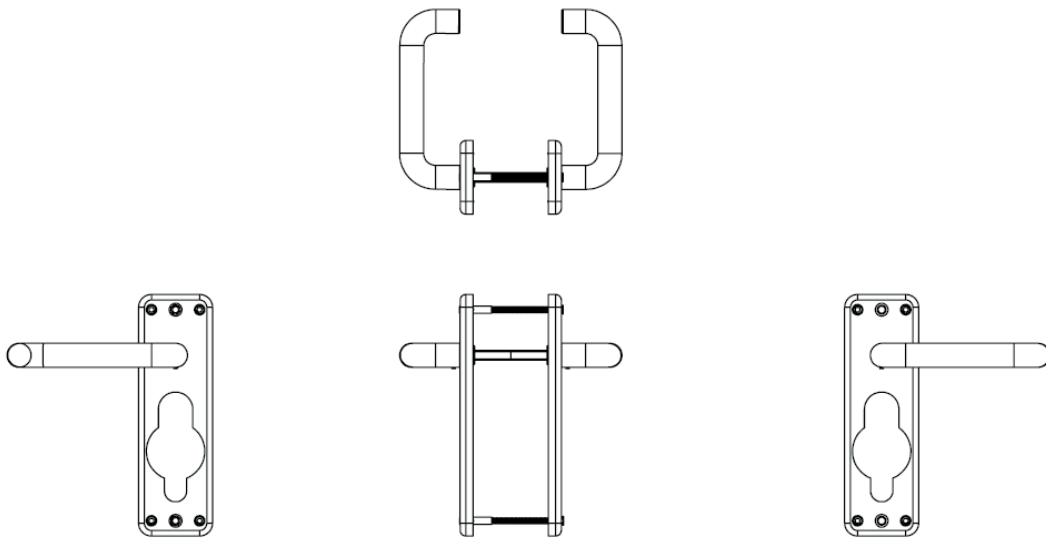
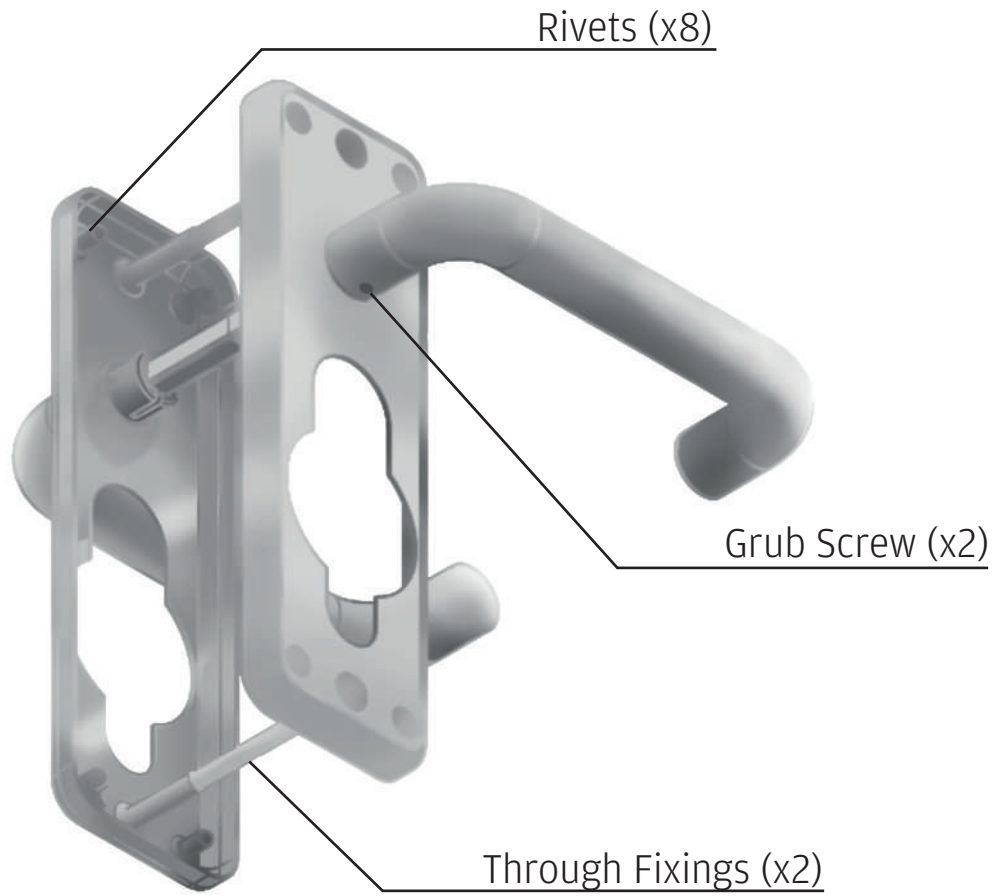

## **1.0 General Cleaning:**

- 1.1 Daily cleaning is recommend for the removal of dust and dirt.
- 1.2 Do not use abrasive cleaning solutions, abrasive papers or alkaline solutions.
- 1.3 Wipe down only! Must not be washed down.

## **2.0 Laminated & Wooden Doors:**

- 2.1 Wipe down periodically using a damp cloth and mild detergent drying with a clean cloth afterwards.

## **3.0 Sliding Doors:**

- 3.1 Lightly oil trolley hangers every 3 to 5 months.
- 3.2 Check the trolley alignment in the track every 3 to 5 months.

## **4.0 Locks & Hinges:**

- 4.1 Duplicate keys can be ordered from Troax Lee Manufacturing Ltd.
- 4.2 Lightly oil hinged every 3 to 5 months.

## **5.0 Bolt Fixings:**

- 5.1 Check bolted fixings to ensure they are still tight every 6 to 12 months.

## **6.0 Glazing:**

- 6.1 Clean glass when necessary using a suitable glass cleaner only.
- 6.2 Wipe down only! Must not be washed down.

## **7.0 Polycarbonate**

- 7.1 Cleaning must be carried out manually. Carefully brushed with a very soft brush to remove any particles. Using a lint free cloth, gently wipe (do NOT rub) with lukewarm water mixed with a mild domestic soap (i.e. Washing-Up Liquid). Rinse thoroughly with clean water and wipe dry with a very soft lint free cloth (do NOT rub)

## **8.0 Door Closers:**

- 8.1 To be maintained as per manufacturers recommendations.

## **9.0 Damaged Items:**

- 9.1 Contact Troax Lee Manufacturing Ltd. for a range of replacement parts, doors, panels & glazing.